

July 11, 2020

Regarding Project No.: CA015-001 & Var18-002
Location 5637 East Mercer Way, Mercer Island, WA 98040
Applicant/Owner: MI Treehouse, LLC (c/o Bill Summers)
Request: City approval of a SEPA Designation of Non-Significance

The following undersigned parties are opposed to the approval of a SEPA Designation of Non-Significance as requested by the Applicant. The undersigned parties believe development of this property will have a negative impact on the safety, health, and welfare of the adjoining properties and properties located downstream from the development site all the way to the shoreline of Lake Washington. The development site is an active Category III Wetland with two Type II Watercourses.

Please sign below and print your name and address:

Gordon J. Ahalt
G.J. Ahalt
9204 SE 57th ST.
Mercer Island, WA
98040

Karin Larson-Pollock
Karin Larson-Pollock
9104 SE 57th ST
MI 98040

Richard M. Duchaine
RICHARD M. DUCHAINE
9304 SE 57TH
MERCER ISLAND, WA
98040

Eliyezer Kohen
Eliyezer Kohen
5428 Parkwood Lane
Mercer Island, WA 98040

Shanna Drake
9320 SE 57TH ST
Mercer Is. WA, 98

Ann Jack
ANN JACK
9168 Parkwood Rince Rd
9180 Parkwood Rince Rd.

Shanna Drake

July 11, 2020

Regarding Project No.: CA015-001 & Var18-002

Xia (Eileen) Su 
9220 Parkwood Ridge Rd,
Mercer Island WA 98040

Lisa Elefson 
9316 SE 57th St.
Mercer Is. WA 98040

Shannon Wilkinson 
9108 SE 57th St.
Mercer Island WA
98040

Mario Kosmickes 
5425 Parkwood Ln
Mercer Island, WA 98040

Willard Samms 
5634 E. MERCER WAY
MERCER ISLAND
WA 98040

July 11, 2020

Regarding Project No.: CA015-001 & Var18-002

Gaofeng Duan

5632 E Mercer Way
Mercer Island, WA 98040



DAVID L. ANDERSON
9200 SE 97TH STREET
MELLER ISLAND, WA 98040



King County

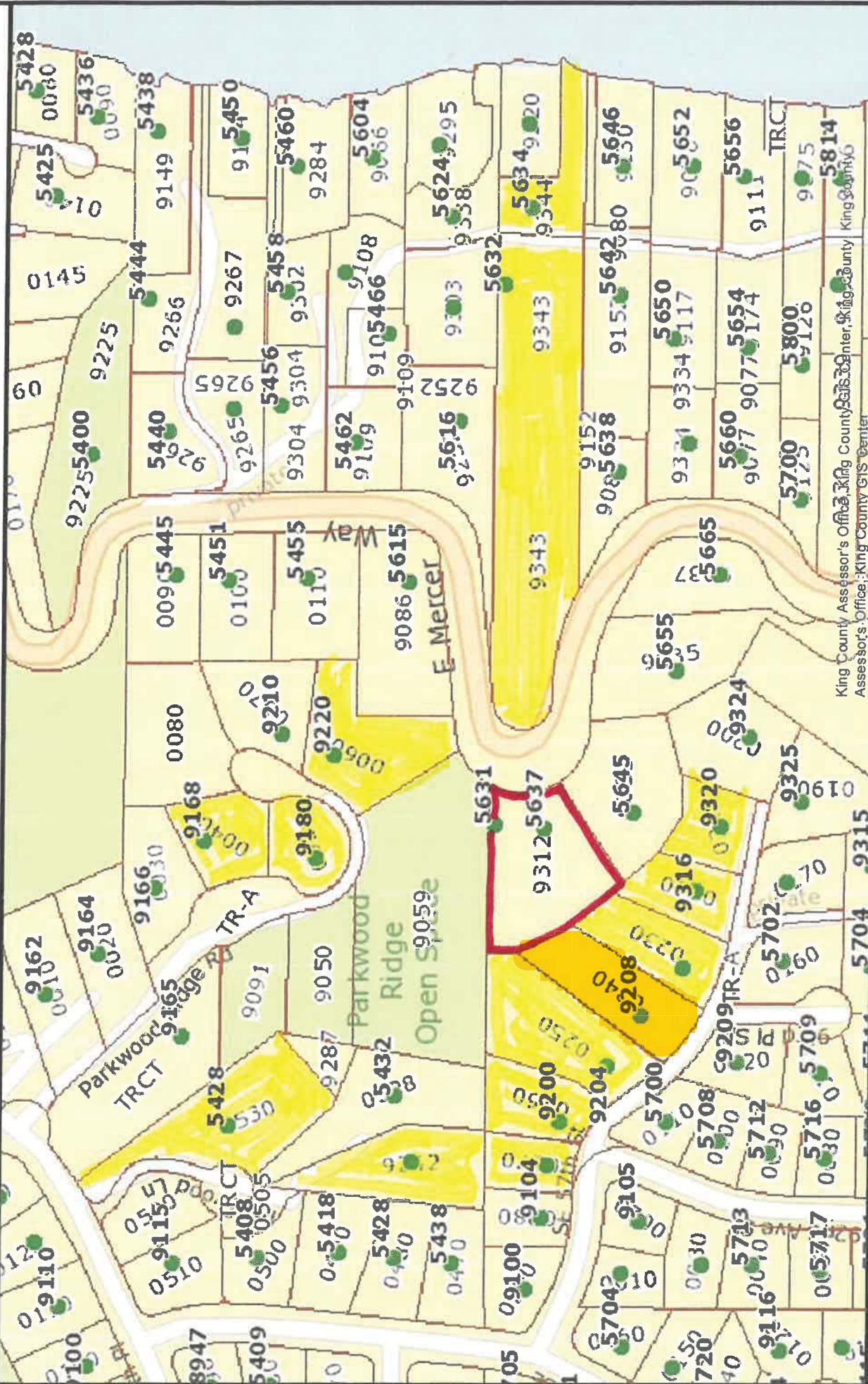

King County Assessor's Office: King County GIS Center
Assessor's Office: King County GIS Center

The information included on this map has been compiled by King County staff from a variety of sources and is subject to change without notice. King County makes no representations or warranties, express or implied, as to accuracy, completeness, timeliness, or rights to the use of such information. This document is not intended for use as a survey product. King County shall not be liable for any general, special, indirect, incidental, or consequential damages including, but not limited to, lost revenues or lost profits resulting from the use or misuse of the information contained on this map. Any sale of this map or information on this map is prohibited except by written permission of King County.

Date: 7/19/2020



King County



Gordon Ahalt

From: Jane Dieckman <jdieck@comcast.net>
Sent: Sunday, July 19, 2020 1:47 PM
To: Gordon Ahalt; evan.maxim@mercergov.org
Cc: Lori
Subject: Petition

We are not able to copy and sign the petition below as we are at our cabin without access to a printer. We do though wish to add our names to the petition.

Thank you,

jane dieckman & Lori Hanson

9208 SE 57th St.

MI

(206) 200-4912 (jane)

July 11, 2020

Regarding Project No.: CA015-001 & Var18-002
Location 5637 East Mercer Way, Mercer Island, WA 98040
Applicant/Owner: MI Treehouse, LLC (c/o Bill Summers)
Request: City approval of a SEPA Designation of Non-Significance

The flowing undersigned parties are opposed to the approval of a SEPA Designation of Non-Significance as requested by the Applicant. The undersigned parties believe development of this property will have a negative impact on the safety, health, and welfare of the adjoining properties and properties located downstream from the development site all the way to the shoreline of Lake Washington. The development site is an active Category III Wetland with two Type II Watercourses.

Please sign below and print your name and address: